

Rep	Nb	Désignation	Matériau	Observation
		KITFER 3		Dessiné par : Roussier Jean-Noël Le: 03 104 1 97
		AERO-IPSA , "Les Mercuriales" , 40 rue J.Jaurès , 93176 BAGNOLET		
		Document n° :	F97301	

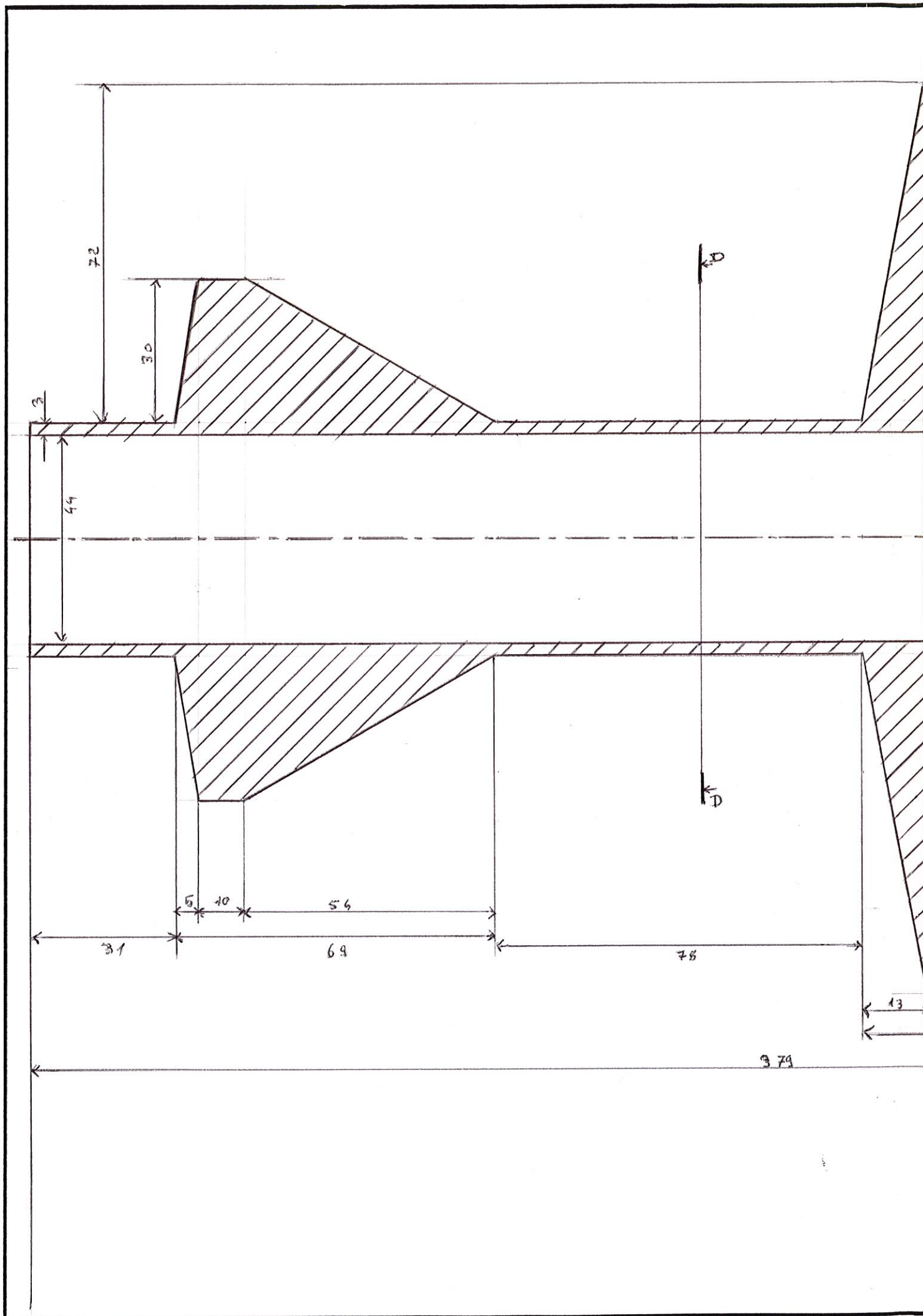

A-A

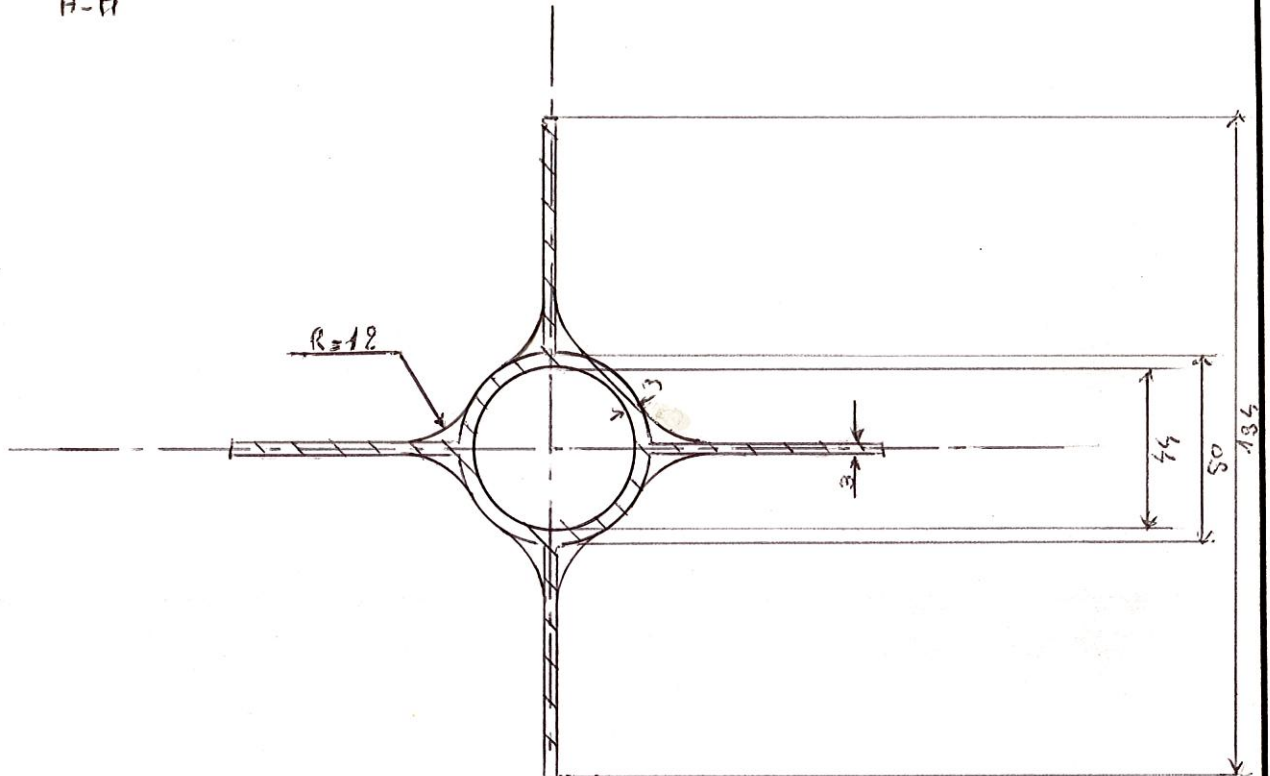

D-D

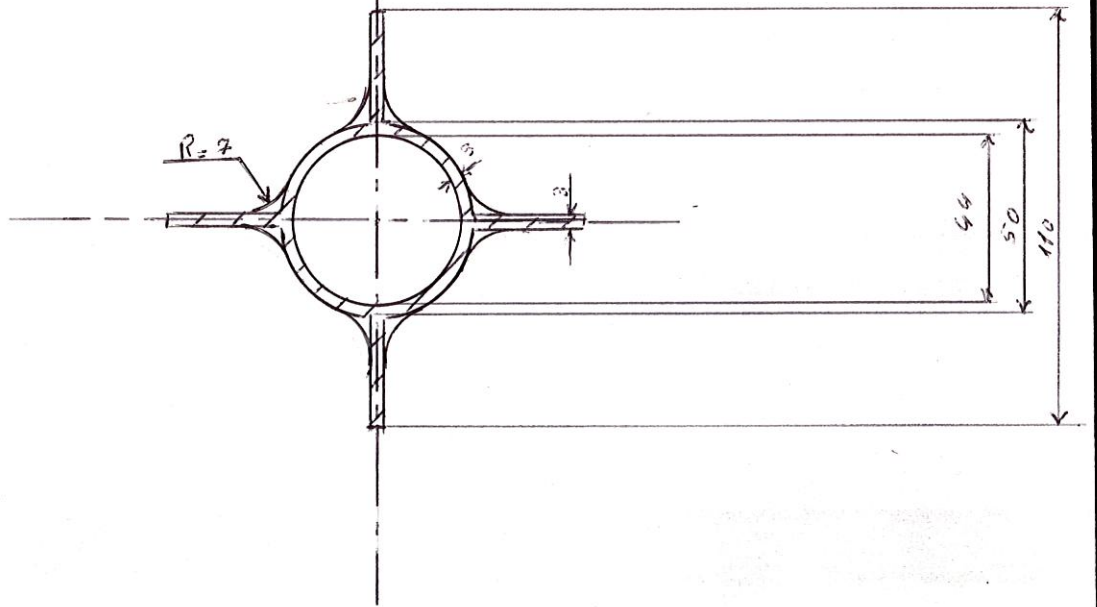

Rep	Nb	Désignation	Matériau	Observation
		Kilfer 4		Dessiné par : moi
	Echelle : 1:2			Le : 04/04/97
		AERO-IPSA , "Les Mercuriales" , 40 rue J.Jaurès , 93176 BAGNOLET		
A4		Document n° : F97302		

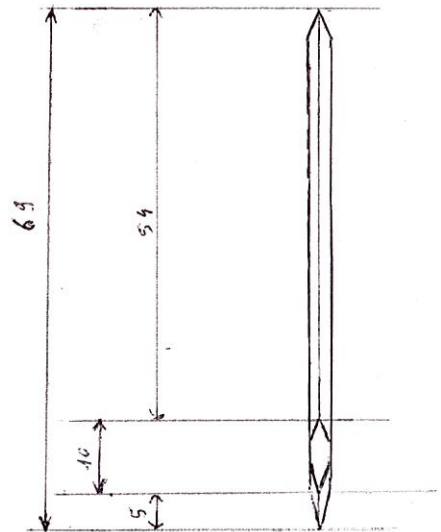
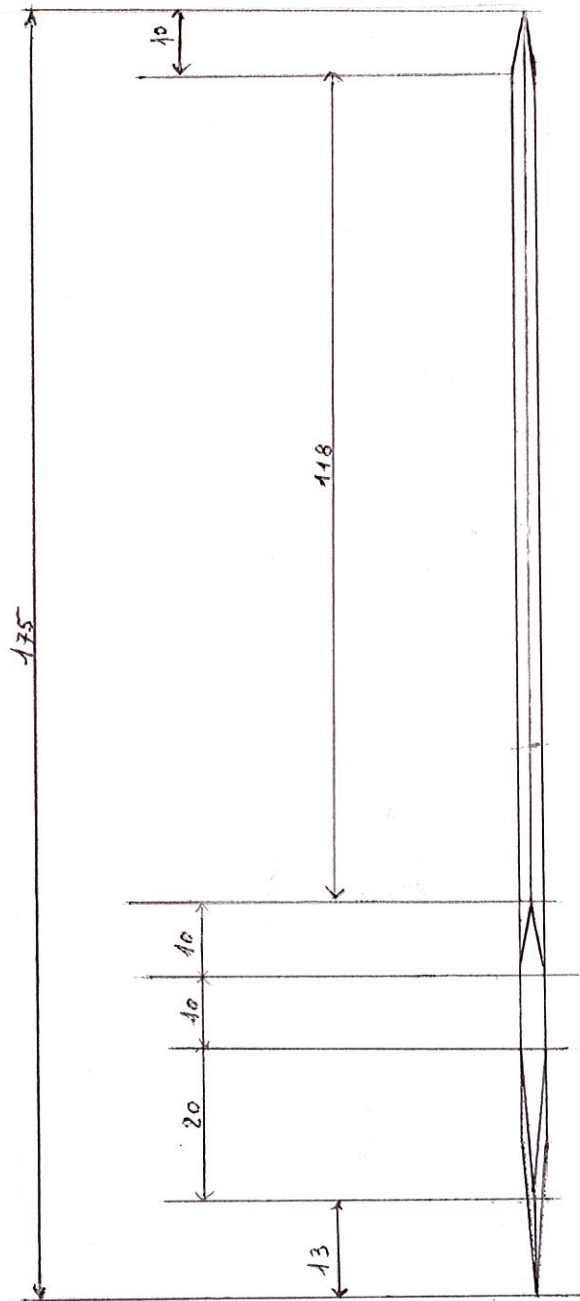

	9	ailerons		
Rep	Nb	Désignation	Matière	Observation
Echelle :	1/1	kilver 5		Dessiné par : Hoi
		AERO-IPSA , "Les Mercuriales" , 40 rue J.Jaurès , 93176 BAGNOLET		Le : 06/09/97
A4		Document n° :	F97304	

A.A

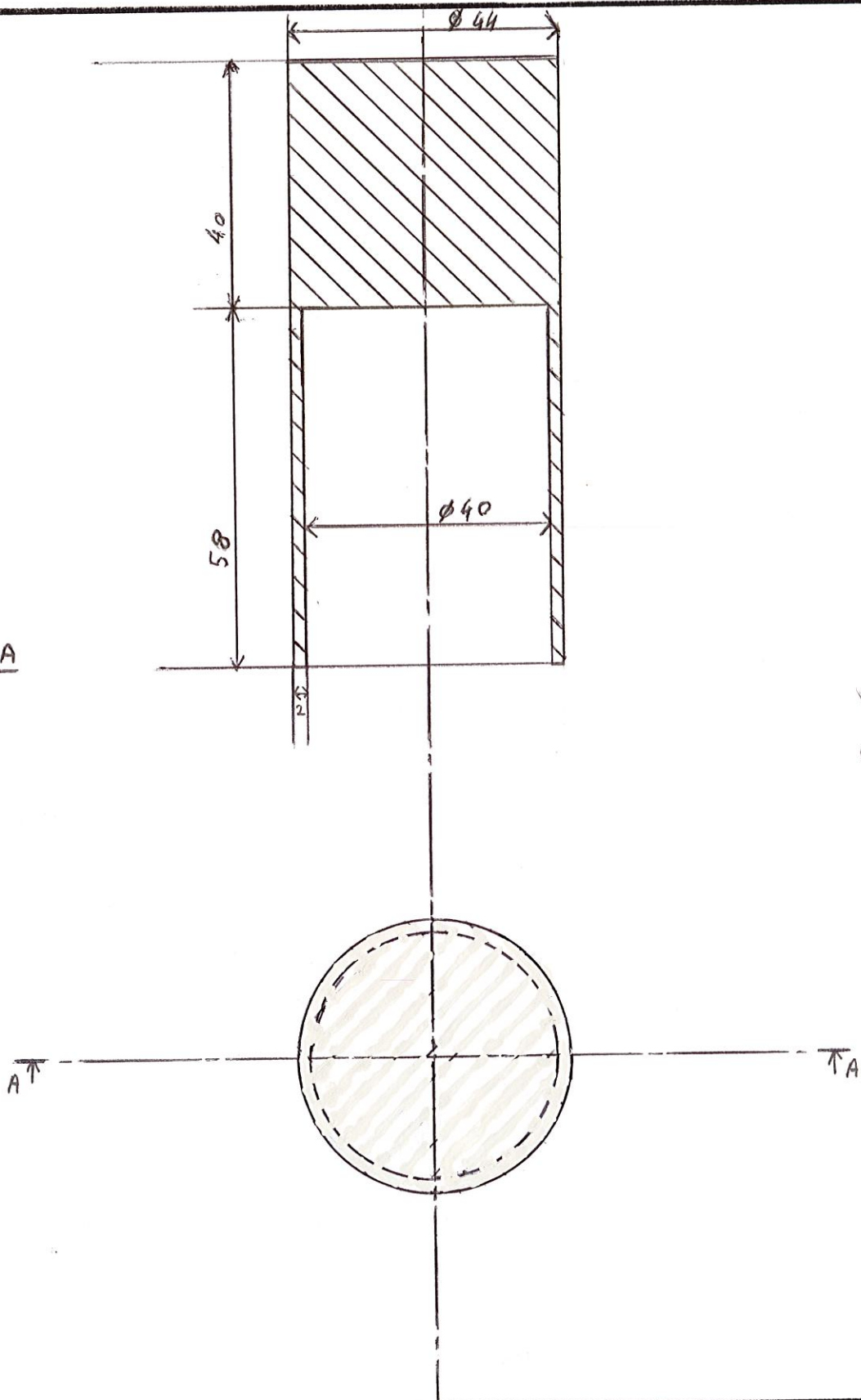

01-43-48-65-93
345A

Rep	Nb	Désignation	Matière	Observation
	1			
Echelle :	1:1	PLAQUE de POUSSÉE		Dessiné par : X.L. Le : 031041987
		AERO-IPSA , "Les Mercuriales" , 40 rue J.Jaurès , 93176 BAGNOLET		
A4		Document n° :	F97303	

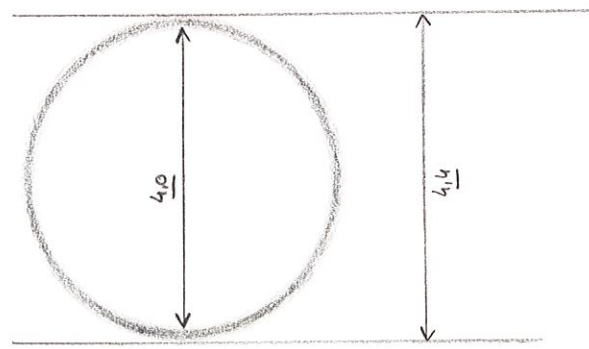
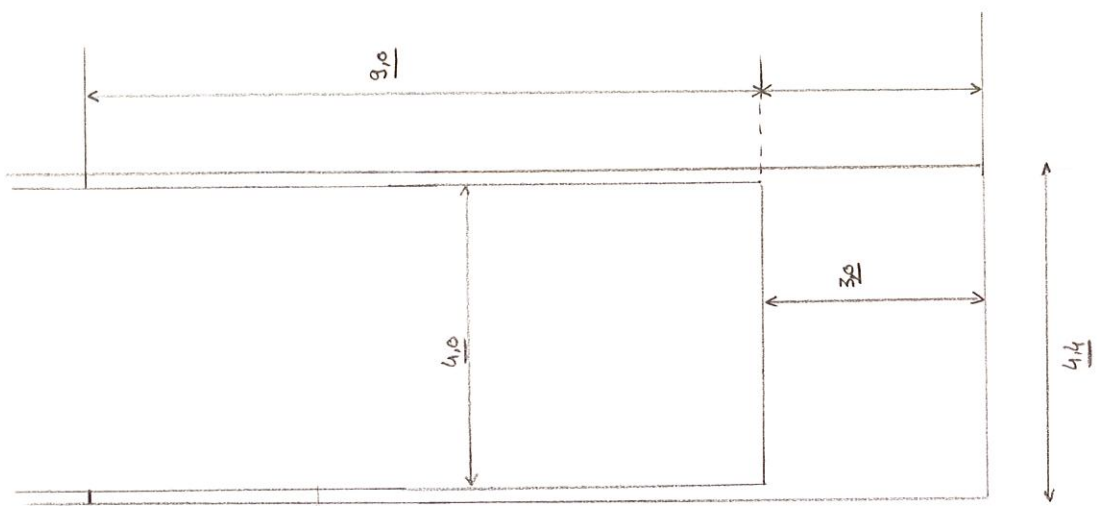

Aléans d'épaisseur $E = 3\text{mm}$

- ① Bords d'attache arrondis sur 1cm
- Bords de fuite effilés sur $0,5\text{cm}$
- ② Bords d'attache arrondis sur $0,5\text{cm}$
- Bords de fuite effilés sur $0,3\text{cm}$

Saumon 1 arrondi sur $0,8\text{cm}$
 Saumon 2 arrondi sur $0,4\text{cm}$

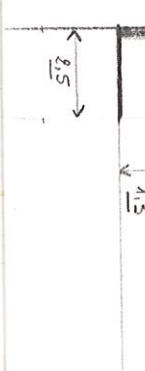
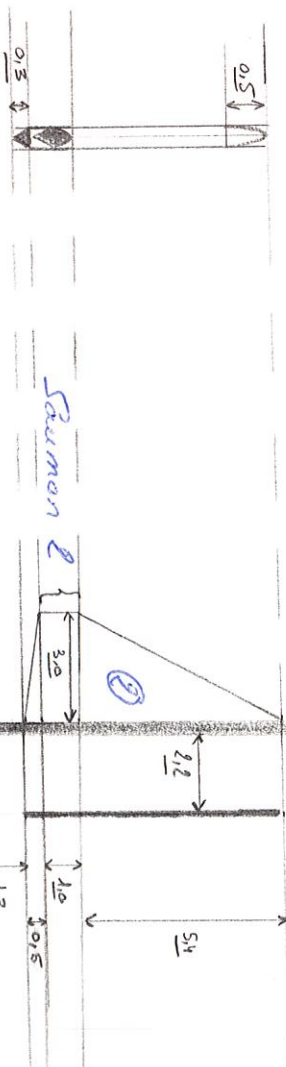
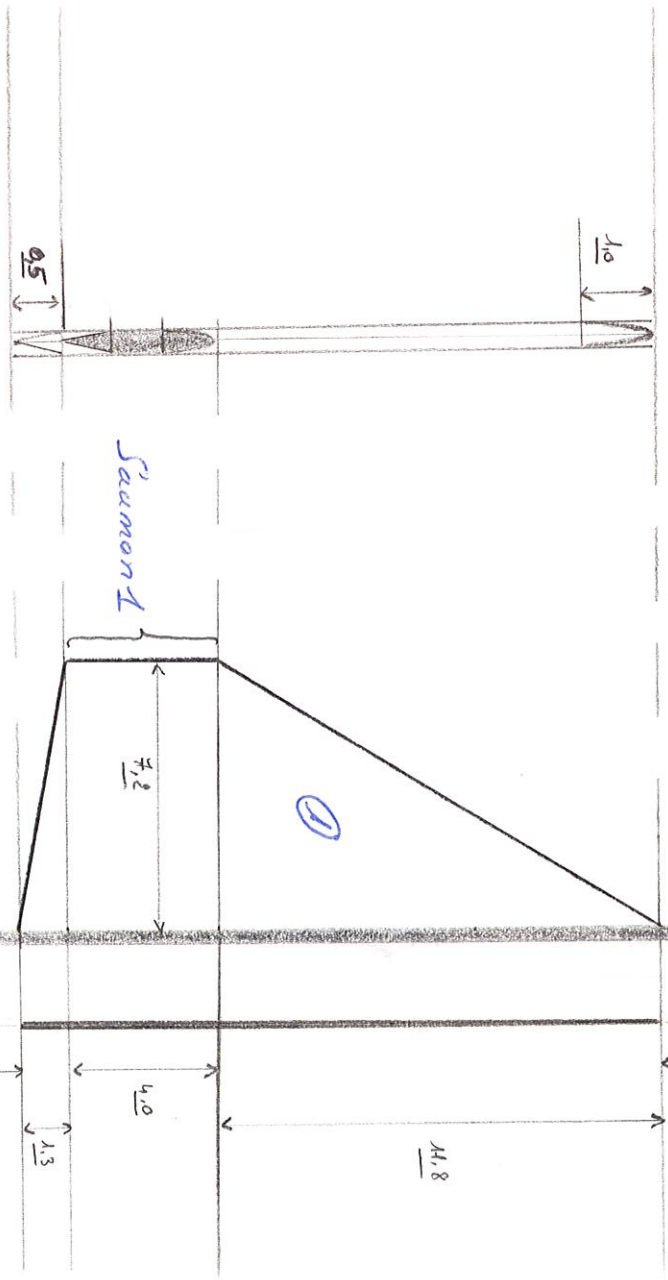
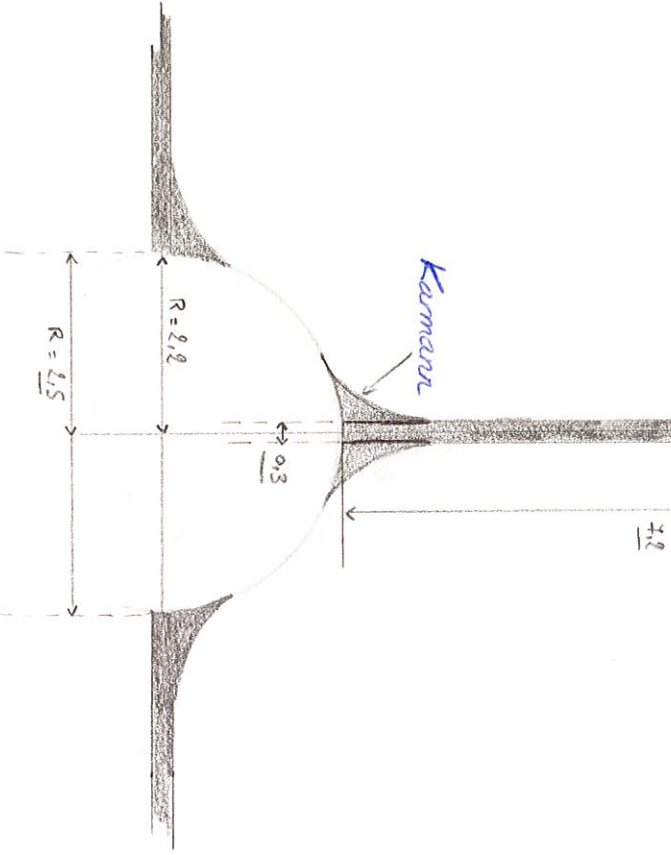

Kilber ech 1/1

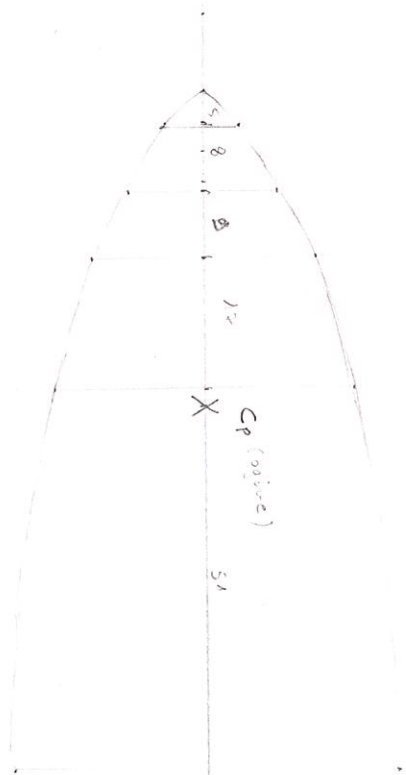

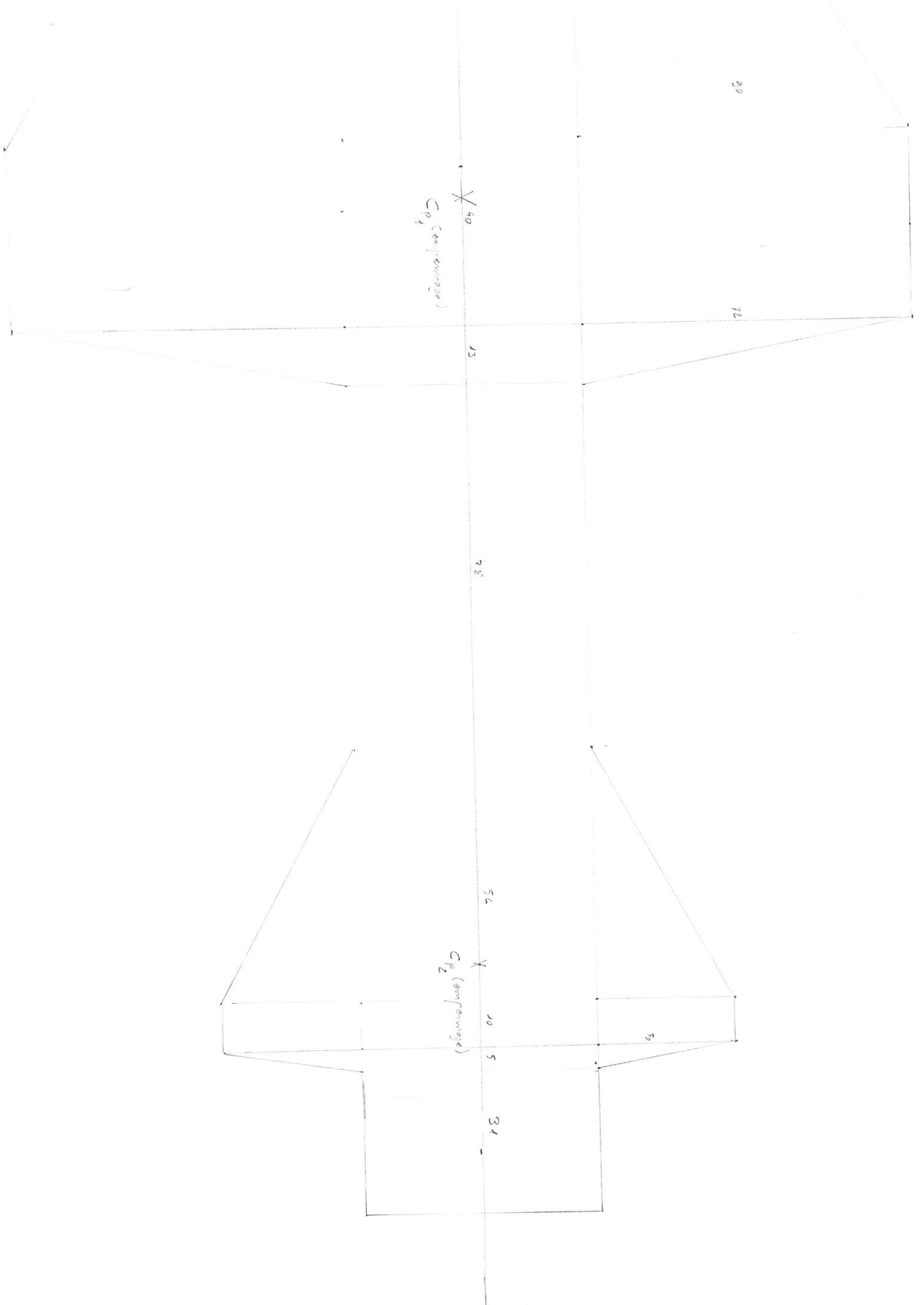

Surface parachute $\Rightarrow 1,2073 m^2$
Vitesse de chute $\Rightarrow 5 m.s$
(Poids $\Rightarrow 2 kg$)

$L_{tot} = 600 mm$

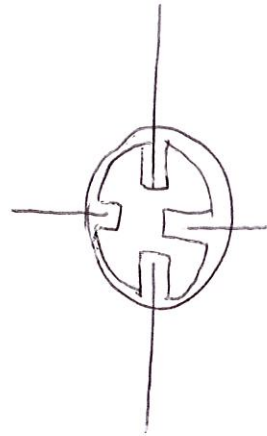

Max

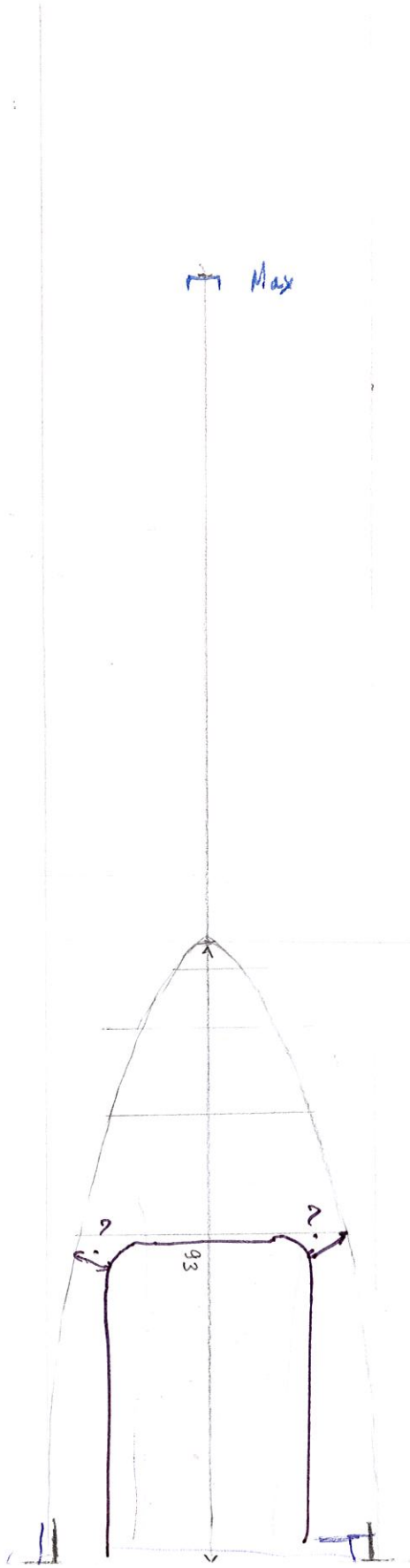
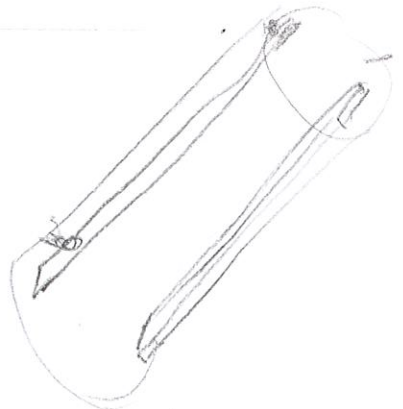

93

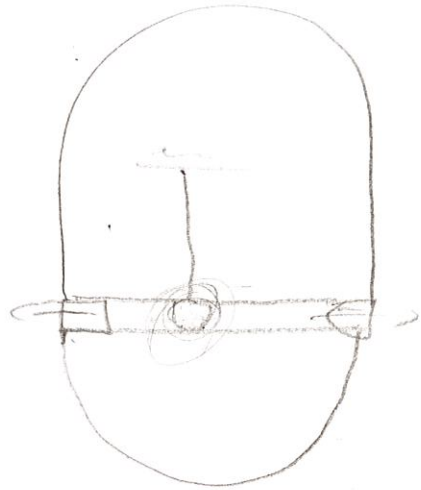
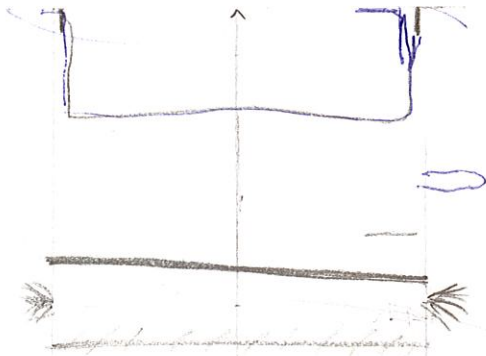

260

Pouç. v.

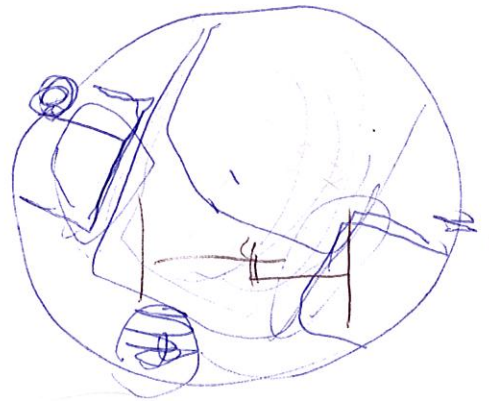

126°

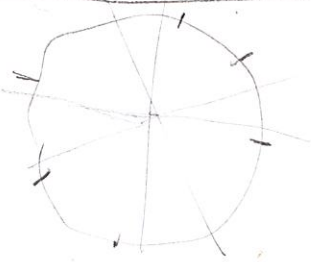

134



118
90
13
141

132

11



46



98

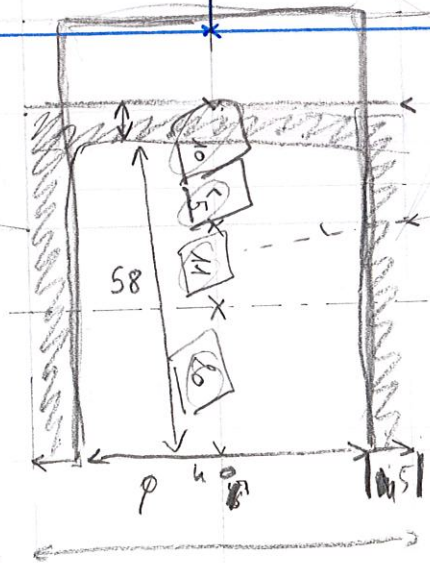
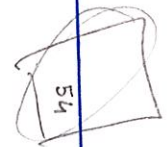
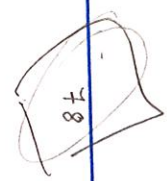
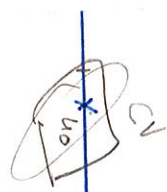
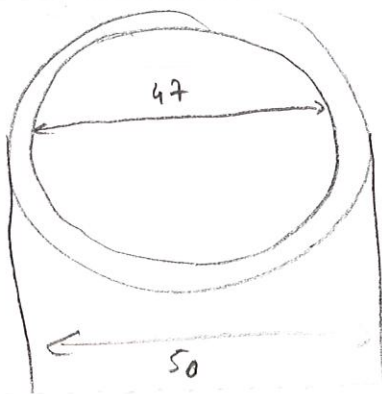

$\phi 50$

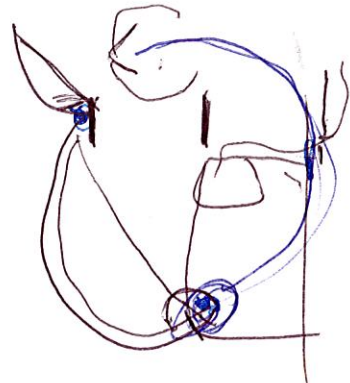

Число
вообра

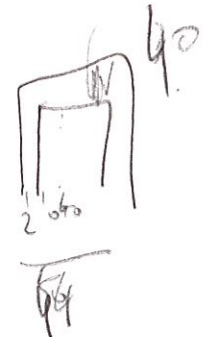

76-18
58

2158
31
69
31
349

350

118 } 158
40 }
132 } 91
78 }
54 } 69
10 }
5 }
112 } 31
20 }